

Schaerer Coffee Soul C TOUCH Utility Specifications

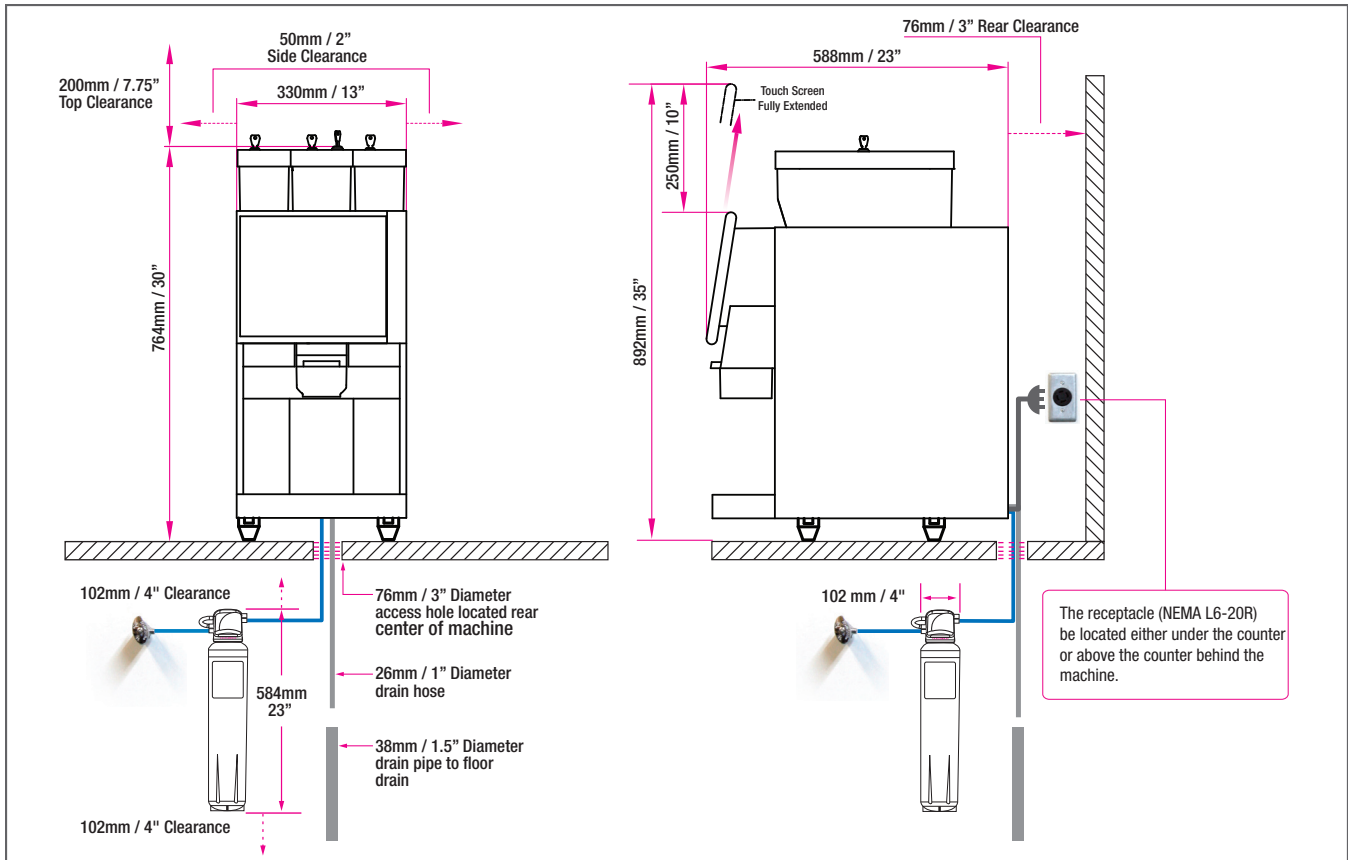

Power, Water Supply, and Access Requirements

	<ul style="list-style-type: none"> • Receptacle type: NEMA L6-20R • 3 Prong twist-lock • Breaker panel: 20 Amp dedicated 220V single phase circuit • Nominal power rating: 2.9–3.8kW • Power supply: 208–240V, 60Hz
	<ul style="list-style-type: none"> • Access hole with collar (no sharp edges) • Located centrally under machine for water and drain hose • Diameter: Minimum 3"
	<ul style="list-style-type: none"> • Water shut-off valve with 3/8" compression fitting • Back flow preventer in accordance with local requirements
	<ul style="list-style-type: none"> • Drain pipe to floor drain • Copper or PVC in accordance with local health codes and regulations • Diameter: 1.5" or larger

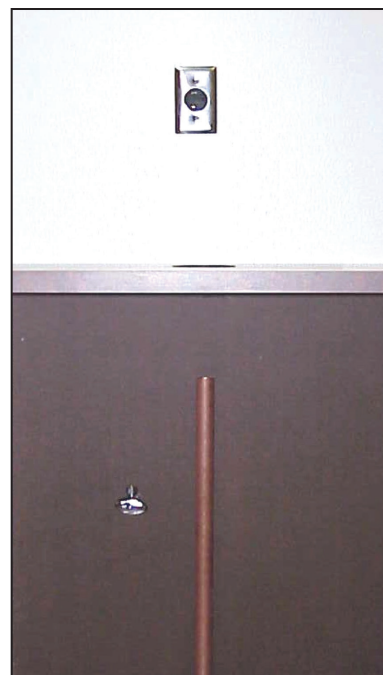

The receptacle, water shut-off valve and drain pipe must be within 3 feet (36") of the center of the location (footprint) of the machine.

Ideal under counter space for softener: 30" (minimum requirement: 26").

Notes: Access hole is only required if any of the utility hook-ups are located under the counter.